

HOMESITE 6

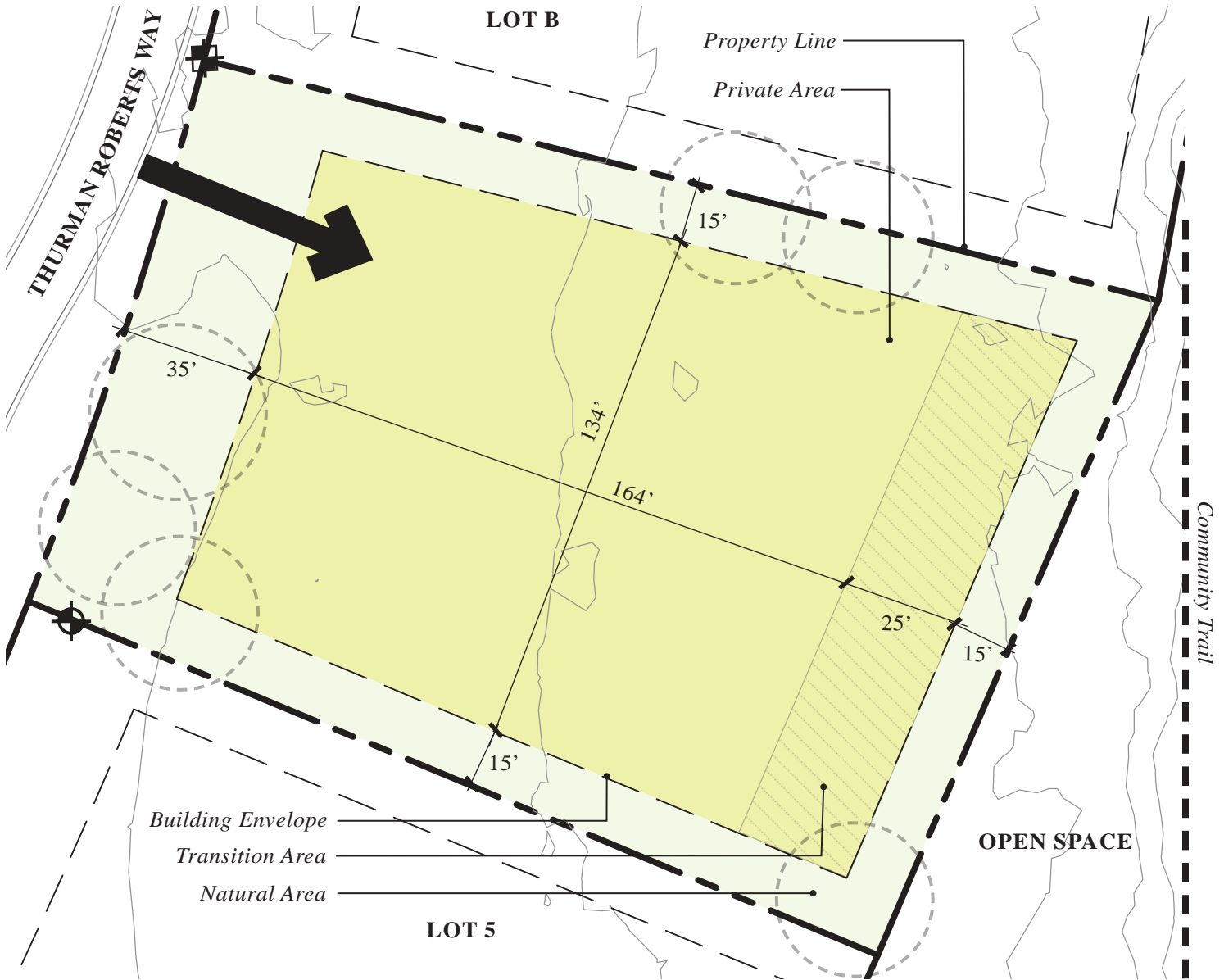

LEGEND

June 12, 2018

- Private Area
- Transition Area
- Natural Area
- Property Line
- Building Envelope
- Suggested Access Point
- Existing Tree to Remain

- + Water P.O.C.
- + Electric P.O.C.
- Maximum Building Height: 34 ft.
- Building Envelope Area: 25,422.95 ft.
(Transition Area: 3,668.51 ft.)
- Natural Area: 13,637.74 ft.
- Total Lot Area: 39,060.69 ft.

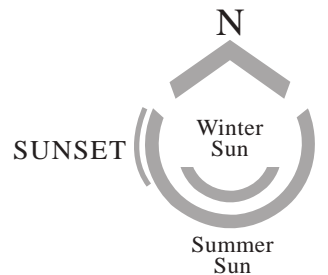

The information depicted on this lot diagram is diagrammatic. Purchasers are advised to verify site conditions prior to commencing construction by obtaining a survey from a registered surveyor.