



RANCH ESTATE NO. 20

RANCH ESTATE NO. 20

Aerial View





Ranch Estate No. 20 sits high on the homesite, spanning 1.2 acres and offering elevated views over Hole #11 tees and fairway.

An even building envelope with mature oak trees in the backyard provides the perfect canvas to design a stunning custom home surrounded by the beauty of the Texas Hill Country. Homeowners will enjoy the privacy of their estate, yet the easy proximity to the future golf clubhouse with indoor and outdoor dining, as well as Discovery's signature locker rooms. With the Tom Fazio-designed golf course just beyond the back patio, this is one of Driftwood's finest real estate opportunities on the market.

RANCH NEIGHBORHOOD

Legend

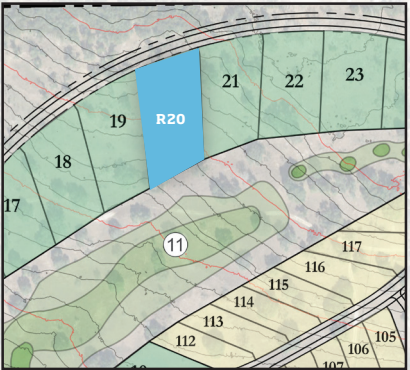

- Ranch Estate No. 20
- Custom Estates
- Villas
- Villas/Custom
- Cabins
- Club Bungalows
- Amenity Buildings

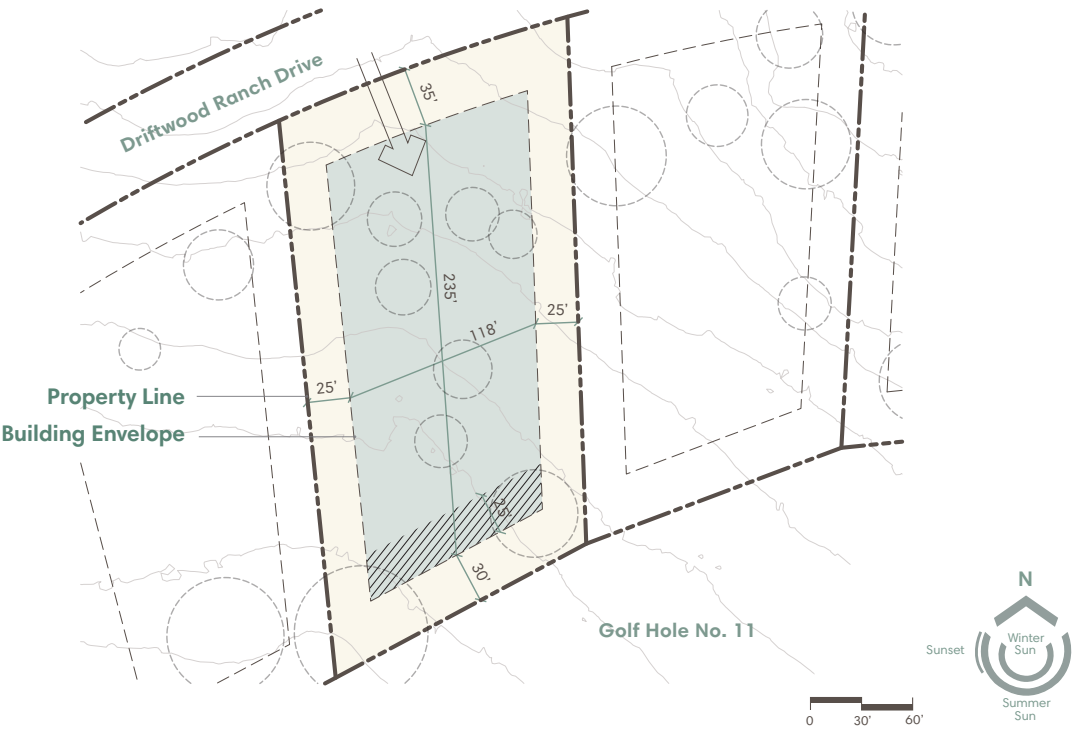

LOT PORTFOLIO



Legend

	Private Area		Suggested Access Point
	Natural Area		Water P.O.C.
	Transition Area		Electric P.O.C.
	Existing Tree to Remain		

Building Envelope Area	28,484 SQ. FT.
Transition Area	2,826 SQ. FT.
Natural Area	23,855 SQ. FT.
Total Lot Area	52,339 SQ. FT.
Total Lot Acreage	1.20 AC
Maximum Building Height	34 FT.

The locations of the Private Area Envelope and other physical structures and height of the pad elevation depicted on this diagram are approximations. Purchasers are advised to verify the same and other site conditions prior to commencing construction by obtaining a survey from a registered surveyor. This lot diagram is preliminary, based on preliminary lot line and grading information. This diagram will be revised when final lot lines and grading information are available.



DRIFTWOOD GOLF & RANCH CLUB

582 Thurman Roberts Way | Driftwood, Texas 78619 | (737) 241-3500

driftwoodgolfclub.com | info@driftwoodgolfclub.com

These materials and the features and amenities described and depicted herein are based upon current development plans, which are subject to change without notice. Obtain the property report required by applicable government authorities before signing anything. No governmental agency has judged the merits or value, if any, of this property. This material shall not constitute an offer to sell in any state where prior registration is required.